



BricsCAD®

Bricsys Customer Story

BricsCAD BIM as the trusted CAD tool for Willemen Construct



Focus on Willemen Construct

Industry:
Construction

Headquarters:
Boerenkrijgstraat 133, 2800 Mechelen
Belgium

For more information
www.willemen.be



A 'user-first' approach

Willemen Construct is one of Belgium's largest construction companies. The company designs, builds, and renovates all types of buildings for many diverse sectors, with a promise to customers that it will deliver the highest quality projects on time and within budget. Willemen Construct relies on BricsCAD BIM as its trusted tool to help deliver on this promise.

Dieter Froyen, Head of Work Preparation Construction, explained why the company chose BricsCAD as its tool of choice for Building Information Management (BIM).

"A project easily consists of hundreds of plans. A person cannot comprehend this, so it is more manageable if all information is contained within one BIM model. By using BIM, many labor-intensive tasks such as drawing up measurement sheets or coordinating plans become automated, which lowers development costs while preventing failure costs."

IMPLEMENTATION OF BRICSCAD BIM

As a contractor, Willemen Construct often works on IFC (Industry Foundation Classes) models from designers, building partners, and suppliers.

"We use 2D plans from the designers as the basis of the project and then create a 3D BIM model of the project from those plans. We usually receive and send out .dwg files which are fully compatible with BricsCAD."

"For projects where there is no BIM model, we apply a reversed engineering approach. By converting building plans into a BIM model, we can provide more precise advice to our suppliers, and accurately calculate material quantities. By checking the design models and eliminating errors in the preparation phase, we avoid failure costs and the associated loss of time during implementation," explained Dieter.

ADVANTAGES OF BRICSCAD

There is a very minimal learning curve required to use BricsCAD, which for Willemen Construct is vital for a wider company rollout.

"We want all project teams at Willemen Construct to use BricsCAD, so it is important that the software is user-friendly and easy to learn which we have found it to be. Also, the integration of 2D, 3D, and BIM in one platform enables a person to grow into a modeler. If they haven't modeled in quite a long time, they can easily pick it up again in BricsCAD. The Quad tool and online learning platform help with that."

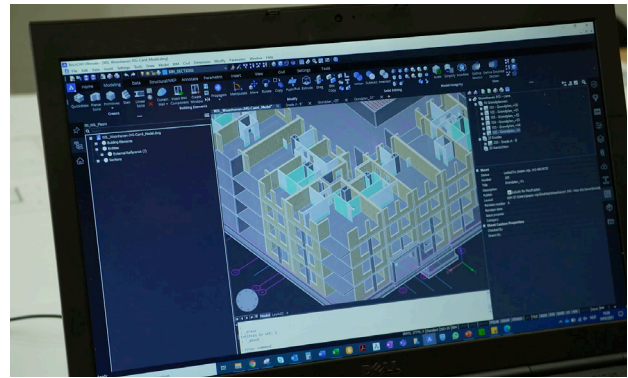

"By checking the design models and eliminating errors in the preparation phase, we avoid failure costs and the associated loss of time during implementation."

— Dieter Froyen, Head of Work Preparation at Willemen

BRICSYS 24/7

For effective collaboration on all design and build projects, Willemen Construct uses Bricsys 24/7 as its preferred document management system.

"Documentation for our construction projects generally consists of more than 10,000 documents and e-mails. A well-thought-out design and proper follow-up of the use of Bricsys 24/7 is crucial to prevent chaos."

LOOKING AT THE FUTURE

"Sustainability analyzes and augmented reality are just some of the many future possibilities to look forward to in BIM. I think the most promising technology is the application of artificial intelligence, which BricsCAD already uses in some applications. For example, through A.I., BricsCAD can identify floors, columns or other building elements automatically."

"We are looking forward to exploring the future capabilities of BIM with Bricsys," concluded Dieter.



In the last two decades, our singular focus has been building cost-effective, mission-critical CAD tools. Built on industry-standard .dwg, our products enable users, CAD managers, and applications software developers to achieve their goals in less time, for less money.

Bricsys - Headquarters
Belgium - Bellevue
5/201 - 9050 Gent
+32 9 244 01 90
info@bricsys.com